

# DUCT IN-LINE

In-line mixed flow fans with high performance air flow capacity and low noise level.

2 SPEED  
3 SPEED

EASY  
MAINTENANCE

- **Fan:**
  - Housing polypropylene plastic.
  - Easy accessible motor due to the motor support, which can be dismantled without interfering existing duct system. (1)
- **Motor:**
  - Asynchronous 1, 2 and 3 speeds motor, self-lubricating bearings for life.
  - Protection **IP44 (IPX2 for DUCT IN-LINE 100/130)** insulation Class B, and thermal cut out, ambient temperature max. 60°C (max. 40°C in Duct in Line 100/130)
  - External terminal box.
  - 60Hz versions on demand.
  - Speed control possible (not timer versions).
  - TIMER version models adjustable from 3 to 15 minutes.
- **Impeller:**
  - High performance and very silence helicocentrifugal mixed flow, made in ABS plastic.
  - **DUCT IN-LINE 100/130** with centrifugal impeller.
- **Accessories:**
  - Fixed plastic grills.



**STANDARD** In combination with light, fans switches on.



**TIMER** Electronic timer adjustable from 3 to 15 minutes.

**DUCT IN-LINE 100/130**

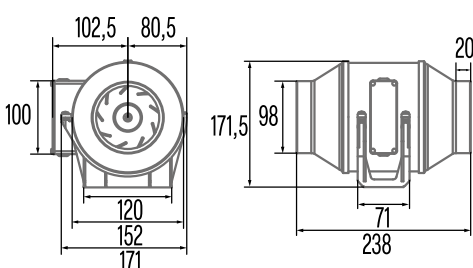

**DUCT IN-LINE 100/270**

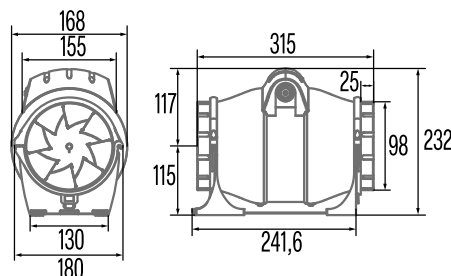

**DUCT IN-LINE 125/320**

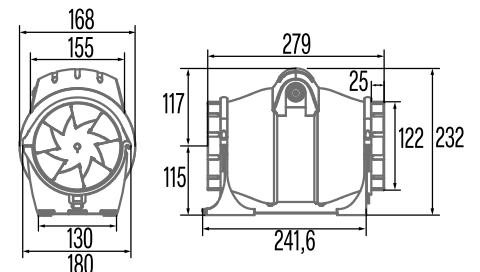

CODE	MODEL	EAN CODE	VERSION	Ø (mm)	Voltage (V)	Speed (r.p.m)	Input Power (W)	Maximum AirFlow (m³/h)	Sound Pressure Level dB(A)	Weight (Kg)	Units per box	110-127V 60Hz on request
<b>TIMER SERIES</b>												
00771000	<b>DUCT IN-LINE 100/130 T</b>	8422248920742	●	100	230	2.200	25	130	24	1,2	4	-
00702100	<b>DUCT IN-LINE 100/270 T</b>	8422248021210	●	100	230	2.300/1.700	30/18	270/190	30/24	2,1	1	-
<b>STANDARD SERIES</b>												
00770000	<b>DUCT IN-LINE 100/130</b>	8422248920735	●	100	230	2.200	25	130	24	1,2	4	✓
00702000	<b>DUCT IN-LINE 100/270</b>	8422248021203	●	100	230	2.300/1.700	40/18	270/190	30/24	2,1	1	✓
00703000	<b>DUCT IN-LINE 125/320</b>	8422248021227	●	125	230	2.300/1.700	40/18	365/250	32/26	2,1	1	✓
00704000	<b>DUCT IN-LINE 150/560</b>	8422248021241	●	150	230	2.700/2.000	70/60	595/420	33/27	3,2	1	✓
00705000	<b>DUCT IN-LINE 160/560</b>	8422248021265	●	160	230	2.700/2.000	70/60	595/420	33/27	3,2	1	✓
00706000	<b>DUCT IN-LINE 200/910</b>	8422248021289	●	200	230	2.700/2.000/1.800	85/65/55	910/820/720	39/34/32	4,5	1	✓



**DUCT IN-LINE 150/560**

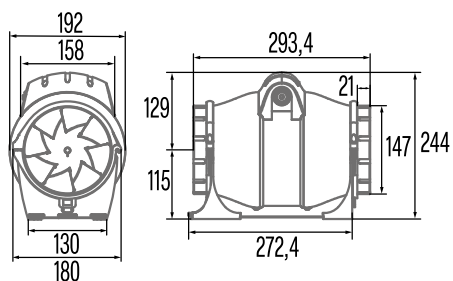

**DUCT IN-LINE 160/560**

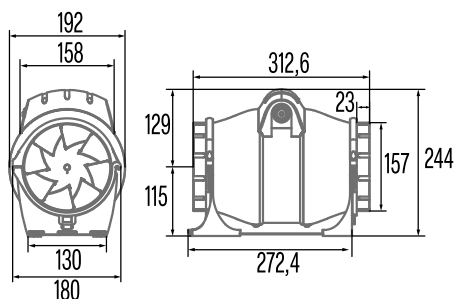

**DUCT IN-LINE 200/910**

